

EIDER 450 S

SURFACE DRILL RIG



DEPTH RATING*

EIDER 450 S	DEPTH RATING		CORE DIAMETER	
	METERS (m)	FEET (ft)	MILLIMETERS (mm)	INCHES (in)
BWL	800	2,600	36.5	1.432
NWL	450	1,476	47.6	1.875
HWL	200	655	63.5	2.500
PWL	70	230	85.0	3.345

*Depth rating is calculated on a 90° hole. It may vary according to in-hole tools, ground conditions, drilling techniques and equipment used.

EIDER 450 S

SURFACE DRILL RIG

DIMENSIONS

DRILL ASSEMBLY

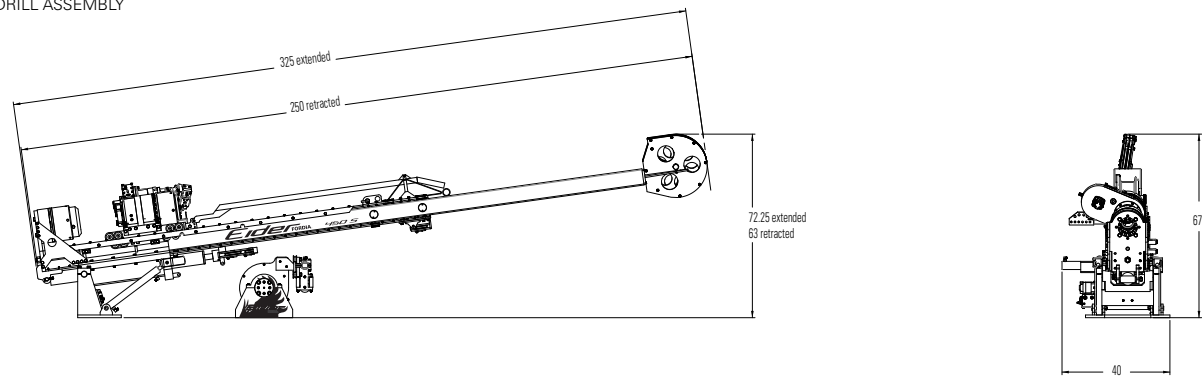

CONTROL PANEL AND POWER PACK

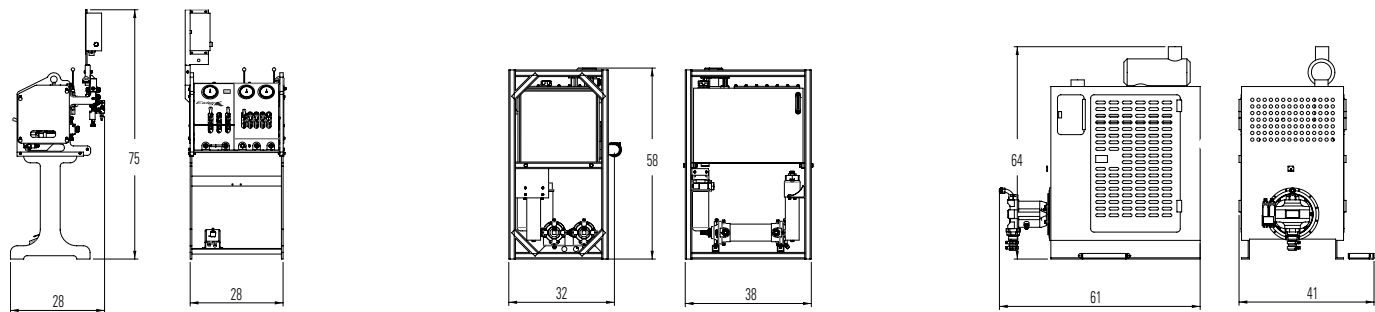

WEIGHT

EIDER 450 S	PARTS	WEIGHT	
		KILOGRAMS (kg)	POUNDS (lb)
Power pack	Engine	635	1,400
	Hydraulic module (wet)	703	1,550
Drill assembly	Feed frame assy (incl. mast base)	927	2,045
	Drill head (incl. hydraulic motor and transmission)	343	755
	Rod holder	90	200
	Wireline hoist	208	460
Control assembly	Control panel	231	510
	Hydraulic hoses	454	1,000

TOTAL NET WEIGHT3,591 kg7,920 lb

EIDER 450 S

SURFACE DRILL RIG

POWER UNIT

EIDER 450 S	ENGINE	POWER	
		HP	kW
Standard	Cummins diesel engine	155	112

ROTARY HEAD ASSEMBLY

EIDER 450 S	METRIC	IMPERIAL
Rotary head motor	80 cc variable	
Chuck operation	Spring closed Hydraulically opened	
Chuck opening	124 mm (4,9 in) PWL rods	
Holding capacity	9,000 kg	20,000 lb
Maximum torque	2,840 N/m	2,098 lb/ft
Maximum speed	1,300 rpm	
Transmission	Mechanic two-speed (3.46:1 and 1:1)	

FEED FRAME ASSEMBLY

EIDER 450 S	METRIC	IMPERIAL
Head stroke	1,83 m	6 ft
Pull capacity	12,700 kg @ 4,000 psi	28,000 lb @ 4,000 psi
Push capacity	8,165 kg @ 4,000 psi	18,000 lb @ 4,000 psi
Angle range	-8° to 90°	

WIRELINE HOIST ASSEMBLY

EIDER 450 S	METRIC	IMPERIAL
Cable capacity	915 m	3,000 ft
Pull capacity (empty)	907 kg	2,000 lb
Pull capacity (full)	295 kg	650 lb
Hydraulic cable guide	Standard	

HYDRAULIC MODULE

EIDER 450 S	DESCRIPTION
Functions	Floating rotary head Torque limit on rotary head and feed cylinder
Hydraulic pumps (2)	147 cc 188 l/min (47 US gal/min) @ 1,800 rpm max. 4,000 psi (275 bar)
	75 cc 136 l/min (36 US gal/min) @ 1,800 rpm max. 4,000 psi (275 bar)
Hydraulic system	Load-sensing circuit
Hydraulic pressurized tank	208 l (55 US gal)

EIDER 450 S

SURFACE DRILL RIG

CUSTOMIZABLE OPTIONS

EIDER 450 S	STANDARD CONFIGURATION	OPTIONS
Drill set-up	Transport skid	Drilling skid Trailer Tracks Truck Other assy upon request
Power unit	Cummins diesel engine 112 kW (155 hp)	Deutz diesel engine
Rod hoist	Pull cable cylinder	Hoisting cable
Hydraulic module	Water cooling system	Air cooling system
Safety	Regular safety guard	Oversize safety guard (VersaGuard) Emergency shut-down control
Structure	Aluminium (85%) and steel (15%)	

